

535

Lifting disks, of forged iron

Item No.	535.001	535.002	535.003	535.004	535.005	535.006	535.008	535.009	535.010	535.011
Dia. x thickness	30 x 4 mm	35 x 4 mm	40 x 5 mm	50 x 6 mm	50 x 8 mm	50 x 8 mm	60 x 8 mm	60 x 8 mm	80 x 10 mm	80 x 10 mm
Thread	M 8	M 8	M 8	M 10	M 12	M 16	M 16	M 20	M 16	M 20
Detaching hole dia.	-	-	-	1 à 8,5 mm	-	-	-	-	-	-
Screw holes	2 à 4 mm	2 à 4 mm	3 à 5,5 mm	3 à 5,5 mm	3 à 6 mm	3 à 6 mm	3 à 6 mm	3 à 6 mm	3 à 6 mm	3 à 6 mm

Other sizes, thicknesses and designs upon request!

536

Lifting disks, of malleable cast iron

with countersunk threaded screw hole and threaded stud

Item No.	Dia. x thickness	Thread	Thread length	Screw holes
536.050	50 x 6 mm	M 12	15 mm	3 à 6 mm
536.075	75 x 9 mm	M 16	24 mm	3 à 6 mm

537

Lifting key, of forged iron, 200 mm long

for lifting plates and disks No. 534 to 536

Item No.	537.008	537.010	537.012	537.016	537.020
Thread	M 8	M 10	M 12	M 16	M 20

538

Reinforcing disks, round

of forged iron

for moulding plates and core boxes with countersunk holes

Item No.	538.001	538.002	538.003	538.004	538.005
Dia. x thickness	30 x 5 mm	32 x 5 mm	50 x 5 mm	50 x 8 mm	60 x 6 mm
Center hole	-	-	-	20 mm	20 mm
Screw holes	1 à 6 mm	1 à 6 mm	1 à 6 mm	3 à 6 mm	3 à 6 mm

Other sizes and designs also available; please specify quantity.

538A

Boring bits

for lifting and reinforcing disks

with straight shank, centering tip, 2 broachers and 2 pre-cutters

Drill dia.	Shank dia.	Item No.		
		WS	HSS	HM
30 mm	13 mm	514.130	514.230	514.330
32 mm		514.132	514.232	514.332
35 mm		514.135	514.235	514.335
40 mm	16 mm	514.140	514.240	514.340
50 mm		514.150	514.250	514.350
60 mm		514.160	514.260	514.360
75 mm	20 mm	514.175	514.275	514.375
80 mm		514.180	514.280	514.380

539

Pivot for moulding plates and core boxes

Item No.	Material	Total length	Total width	Max. depth	Pivot dia.	Weight
539.001	GGG-40	180 mm	40 mm	80 mm	28 mm	1 kg
539.050	GGG-50	200 mm	100 mm	115 mm	50 mm	4 kg

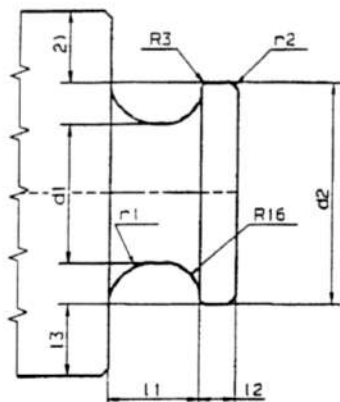
539A

Lifting lugs of PORESTA-styrene

for cast iron and steel as well as spheroidal graphite iron castings

The pivots are dimensioned so that – with the help of a minimum of two pivots castings weighing up to 20.000 kg can be lifted (max. straddle angle at hook 90 degrees).

Item No.	d1	d2	l1	l2	l3	r1	r2
539.104	40	70	36	13	32	20	5
539.105	50	80	36	13	32	20	
539.106	63	100	40	16	32	20	
539.108	80	140	50	20	40	32	10
539.110	100	160	56	25	40	32	
539.112	125	185	63	25	63	32	
539.114	140	200	71	30	63	40	